



Trainfest EXPRESS

Trainfest
Nov. 14 - 15, 2015
WI State Fair Park

www.trainfest.com

Pre-Show
Issue

Volume 5
Issue 3



What's Inside

Trainfest 2015 Floor
Plan
PG 4

Trainfest 2015
Exhibitor Listing
PG 6

ScaleTrains.com on
Fast Track to Success
PG 12

Celebrating the
Chicago &
North Western
PG 15

Trainfest 2015
Clinic Schedule
PG 20

Kids' Activity Zone
PG 22

TRAINFEST
KIDS
PASSPORT
INSIDE

WIN A TRAIN SET

Visit
Trainfest.com
for more
details

Welcome to Trainfest 2015!

Trainfest is just days away, the Trainfest Committee and myself are excited about all Trainfest 2015 has to offer. For the second year Trainfest will be occupying two buildings at the WI State Fair Park, the Expo Center and the "Trainfest Trolley Barn." We've brought some new additions to the show that are sure to delight model railroaders and families alike.

Trainfest is an opportunity to immerse oneself into the world of model trains; it's a weekend full of family fun! This weekend the WI State Fair Park is your destination for all things trains.

In this issue of Trainfest EXPRESS you will find a full review of the new Kids' Activity Zone. The train ride is back this year and we have moved the Kids' Zone inside the tracks. From the hugely popular Make 'n Take clinics to Choo Choo Bob and our youngest train



layout exhibitor, the Kids' Activity Zone is a dream come true for young train fans. Over the past few months we have begun to see the elements of the Celebrate-a-Railroad program come together. The painting of the Milwaukee Depot and the the Chicago & North Western has been completed, and is phenomenal. The limited run C&NW boxcar is available for pre-sale at Trainfest.com/shop, get your order in by Thursday to pick it up at Trainfest!

The cornerstone of the Celebrate-a-Railroad program is a museum quality historical photo display. We've combed through acres of the C&NW Archives to put together a comprehensive display of the C&NW's long proud history. Walking through the display, visitors will travel through time discovering the founding, golden days, and functions of the C&NW system.

I look forward to seeing you at Trainfest!

Enjoy!

Ken

Ken Jaglinski
Trainfest Chair

Trainfest EXPRESS is sent free via email as a PDF or can be viewed on the Trainfest website in an interactive, online paging-style format. You can also print out the pages or articles you desire.

We continue to look for your input on articles you would like to see in the EXPRESS. Send them to us at kenj@trainfest.com or editor@trainfest.com.

Trainfest EXPRESS

Sponsoring Publisher

Wisconsin Southeastern
Division, Inc., NMRA

Contributing Editors

Angela Podewils
Bonnie Moyer Topczewski
Alexandra Wietecka

Newsletter Design, Web & Advertising

Mercury Communication
Partners, LLC
262-782-4637
www.mercuryww.com

Photos Contributed by

Jeremy Topczewski
Tim Bigonia

TRAINFEST, Trainfest EXPRESS and the Trainfest LOGO are registered trademarks of the Wisconsin Southeastern Division, Inc., NMRA.

www.trainfest.com

TRAINFEST COMMITTEE

Ken Jaglinski
Trainfest Committee Chair

Harry Grieshaber
Floor Director

Bob Henderson
Show Office Director/ Volunteers

Keith Schmidt
Security

Mark Willmering
Ingress/Egress

LeRoye Chisley
Make & Take

Dennis Janssen
Onsite Clinic
Director/ Finance

Burnell Breaker
Trainfest Trolley
Barn Director

Jeffrey Marker
Advertising Chair

Reid Kahrs
WISE Superintendent

Mercury Communication Partners
Advertising Agency

Terry Thompson
HMA-MRD Advisor

John H. Tews, MMR
Advisor

SEE THE DIFFERENCE*



*Magnifying glass included

We invite you to see the difference at booth **#3114** as we make our company debut at **Trainfest**® 2015. You won't believe your eyes when unveil our first HO scale **Museum Quality**™ locomotive. We're looking forward to meeting you and sharing our new product announcements. Be sure to sign-up for our free e-mail newsletter at **ScaleTrains.com**™ and like our Facebook page too.

© 2015 ScaleTrains.com, Inc. ScaleTrains.com, Museum Quality, and respective logos are trademarks of ScaleTrains.com, Inc. Trainfest and logo are registered trademarks of the WISE Division, Inc. of the NMRA and is used with permission.

ScaleTrains.com, Inc. 7598 Highway 411 Benton, TN 37307 844-9TRAINS 844-987-2467

Trainfest 2015 Floor Plan

TRAINFEST TROLLEY BARN

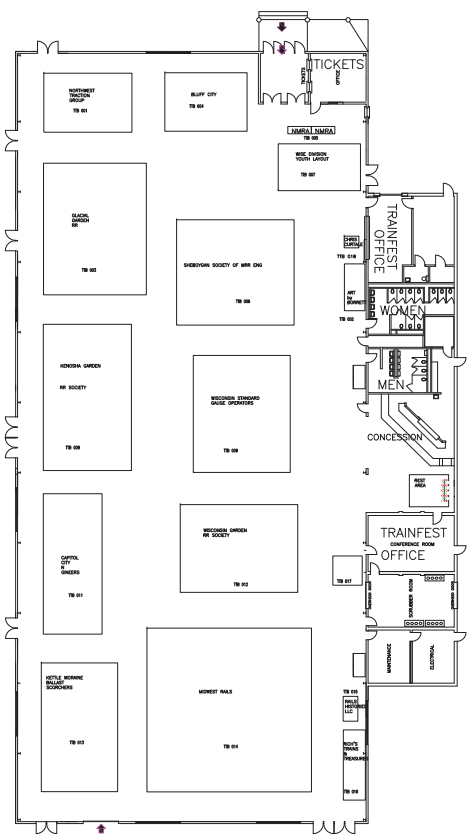

WISCONSIN STATE FAIR PARK
WISCONSIN PRODUCT PAVILION

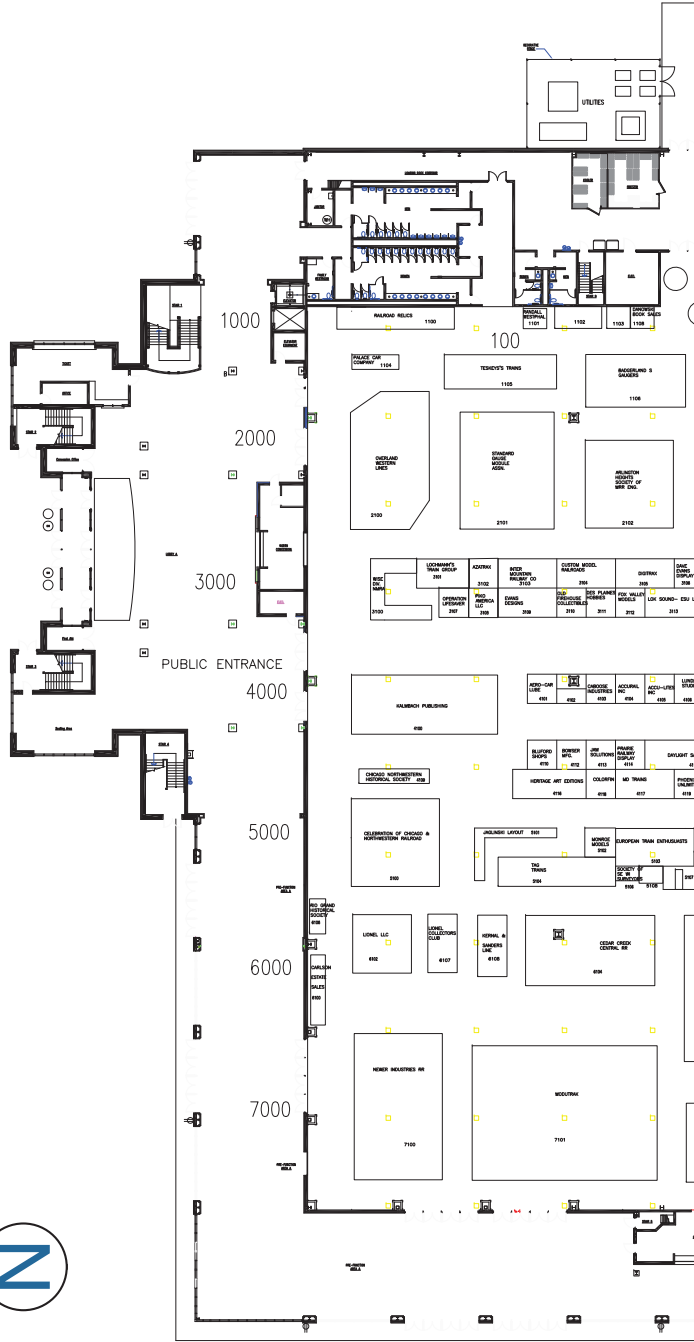

WISCONSIN EXPOSITION CENTER

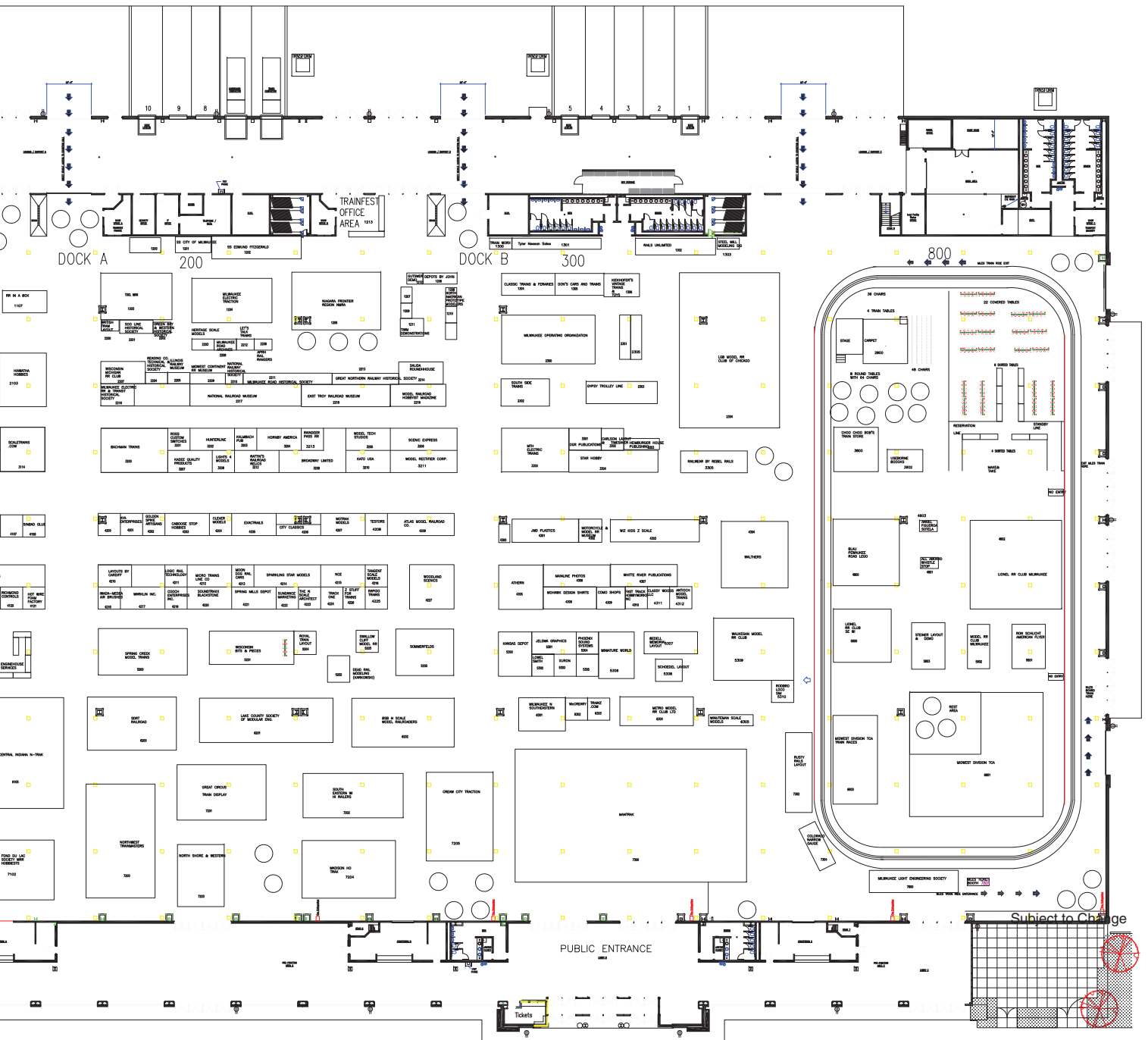

Trainfest 2015 Exhibitors



Manufacturers

Name	Booth
Accu-Lites Inc	4105
Accurail Inc.	4104
Aero-Car Hobby Lubricant	4101
Athern - Horizon Hobby	4305
Atlas Model Railroad Co.	4209
AYA Enterprises	4201
AzaTrax	3102
Bachman Trains	3200
Bluford Shops LLC	4110
Bowser Mfg	4112
Broadway Limited	3209
Caboose Industries	4103
Chooch Enterprises Inc	4219
City Classics	4206
Classy Woods LLC	4311
Clever Models LLC	4204
Colorfin	4118
Custom Model Railroads	3104
Daylight Sales	4115
Des Plaines Hobbies	3111
Digitrax	3105
Evans Designs	3109
ExactRail	4205
Fast Track Hobbyworks Inc	4310
Fox Valley Models	3112
Golden Spike Artisans Group	4202

Name	Booth
Heritage Art Editions	4116
Hornby America	3204
Hot Wire Foam Factory	4121
Hunterline	3202
Inter Mountain Railway Co	3103
Iwata - Medea	4218
JAM Solutions Inc	4113
Kadee Quality Products Co.	3207
Kalmbach Publishing	4100
Kalmbach Publishing	3203
Kato USA	3210
Layouts by Cardiff	4210
Lights 4 Models	3208
Lionel Collectors Club	6107
Lionel LLC	6102
Logic Rail Technologies	4211
LokSound - ESU LLC	3113
Lunde Studios	4106
Marklin Inc.	4217
Micro-Trains Line Co.	4212
Minuteman Scale Models	6305
Model Rectifier Corp	3211
Model RR Hobbyist Magazine	2219
Model Tech Studios	3205
Monore Models	5102
Moon Dog Rail Cars	4213

Name	Booth
Motrak Models	4207
MTH Electric Trains	3300
NCE	4215
OGR Publishing Inc.	3301
Phoenix Sound Systems	5304
Phoenix Unlimited	4119
Piko-America LLC	3108
Rapido Trains	4225
Richmond Controls	4120
Ross Custom Switches	3201
RR in a Box	1107
ScaleTrains.com	3114
Scenic Express	3206
Sinbad Glue	4108
Soundtraxx/Blackstone	4220
Spring Mills Depot	4221
Sundance Marketing	4222
Tangent Scale Models	4216
Testor Corp	4208
The N Scale Architect	4223
Train Worx	1300
White River Productions	4307
Wm. K Walthers Inc.	4304
Woodland Scenics	4227
Xuron Company	5303
Z-Stuff for Trains Inc	4226

Trainfest 2015 Exhibitors

Vendors

Name	Booth
Art by Rick Borrett	TTB 002
Caboose Stop Hobbies	4203
Carlson Estate Sales	6100
Charles McCreary	6302
Choo Choo Bob's Train Store	3800
Chris Curtale	TTB 018
Classic Trains & Ferraris	1304
Como Shops	4309
Danowski Book Sales	1108
Don's Cars & Trains	1305
Enginehouse Services	5107
Heimburger House Publishing	3303
Jelmsa Graphics	5301
Jetco's Hiawatha Hobbies	2103
JMD Plastics	4301
Kansas Depot	5300
Lochmann's Train Group	3101
Lowell Smith Signature Series	5302
Mainline Photos	4306
MD Trains	4117
Miniature World	5306
Mohawk Design Shirts	4308
Motorcycle & Model RR Museem	4302

Name	Booth
Old Firehouse Collectibles	3110
Palace Car Company	1104
Prairie Railway Display	4114
Rail Histories, LLC	TTB 015
Railroad Relics	1100
Rails Unlimited	1302
RailWear by Rebel Rails	3305
Rattin's Railroad Antiques	5105
Reindeer Pass RR	
Rich's Trains & Treasures	TTB 016
Salida Roundhouse	2214
Sommerfelds	5205
South Side Trains	2302
Sparkling Star Models	4214
Spring Creek Model Trains	5200
Star Hobby	3304
Tag Trains	5104
Teskeys's Trains	1105
Tool Man	1203
Track One	4224
Trainz.com	6303
Tyler Neesan Sales	1301
Useborne Books	3802

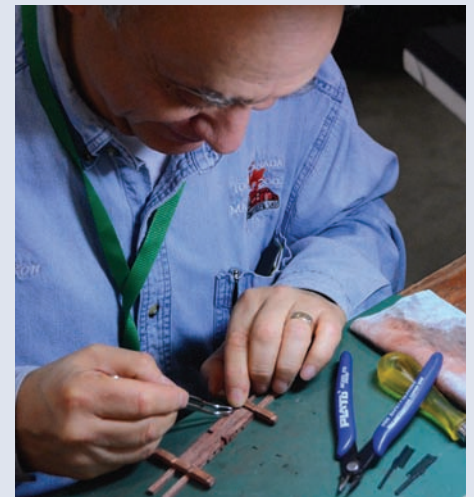

Historical

Name	Booth
APRHF Rail Rangers	2206
Chicago Northwestern Historical Soc	4109
Green Bay & Western Historical S.	2202
Milwaukee Road Historical Society	2211
Rio Grande Modeling & Historical	6106
Soo Line Historical Society	2201
Great Northern Railway Historical S.	2213
Milwaukee Road Archives	2208
National Railway Historical Soc	2210
Reading Co. Historical Society	2204



Trainfest 2015 Exhibitors

Layout

Name	Booth
Angel Figueroa Sotelo (7 yr old)	4803
Arlington Heights Society of MRR Eng	2102
Badgerland S Gaugers	1106
Blau Pewaukee Road Lego	4800
Bluff City Modular Engineers	TTB 004
British Tram Layout	2200
BSB N Scale Model Railroaders	6202
Capital City N Gineers	TTB 011
Carlson Layout & Timesaver	3302
Cedar Creek Central RR	6104
Central Indiana N-Trak	6105
Colorado Narrow Gauge	7304
Cream City Traction	7205
Dead Rail Modeling in HO (Karkowski)	5202
European Train Enthusiasts	5103
Fond du Lac Society of MRR Hobbies	7102
Glacial Gardern RR	TTB 003
Gypsy Trolley Line	2303
Jaglinski Layout	5101
Kenosha Garden RR Society	TTB 008
Kernels & Sanders Line	6108

Name	Booth
Kettle Moraine Ballast Scorchers	TTB 013
Lake County Society of Modular Eng	6201
LGB Model RR Club of Chicago	2304
Lionel RR Club Milwaukee	4802
Lionel RR Club SE WI	5800
Madison HO Trak	7204
MANTRAK	7300
Metro Model RR Club Ltd	6304
Midwest Division TCA	6801
Midwest Division TCA Train Races	6800
Midwest Rails	TTB 014
Milwaukee Electric Traction	1204
Milwaukee Light Enginerring Society	7800
Milwaukee N Southeastern	6301
Modutrak	7101
MOO Crew	2300
Newer Industries Railroad	7100
North Shore & Western	7203
Northwest Traction Group	TTB 001
Northwest Trainmasters	7200
Overland Western Lines	2100

Name	Booth
Randall Westphal	1101
Ron Schlicht - American Flyer	5801
Royal Train Layout	5204
Rusty Rails Layout	7302
Schoedel Layout	5308
SDRT Railroad	6200
Sheboygan Society of MRR Eng	TTB 006
Southeastern WI Hi-Railers	7202
Standard Gauge Module Assn	2101
Steiner Layout & Demo	5803
Swallow Cliff Model RR	5203
Waukegan Modular RR Club	5309
Wisconsin & Michigan RR Club	6103
Wisconsin Bits & Pieces	5201
Wisconsin Gardern RR Society	TTB 012
Wisconsin Standard Gauge Operators	TTB 009
WISE Division NMRA TTB	TTB 005
WISE Division Youth Layout	TTB 007
WIZ KIDS Z SCALE	4303



Trainfest 2015 Exhibitors

Display

Name	Booth
Bedell Memorial Layout & Display	5307
Dave Evans Display	2100
Depots by John	1206
Dreschler, John	1209
East Troy Railroad Museum	2218
Great Circus Trains Display	7201
Gutzmer Demo	1212
Illinois Railway Museum	2205
Kiekhofer's Vintage Trains & Toys	1306
Let's Talk Trains	2212
Mid Continent RR Museum	2209
Milwaukee Electric RR & Transit Hist	2216
Model RR Club of Milwaukee	5802
National Railroad Museum	2217
Niagara Frontier Region NMRA	1205
North American Prototype Modelers	1208
Operation Lifesaver	3107
Rodbro Locomotive Simulator	5310
Society of SE WI Land Surveyors	5106
SS City of Milwaukee	1201
SS Edmund Fitzgerald	1202
Stage	2800
Steel Mill Modeling SIG	1303
Timm Demonstrations	1211
WISE Division NMRA	3100





- AzaTrax
- Model Railroad Hobbyist Magazine
- Classy Woods LLC
- Des Plaines Hobbies
- Colorfin
- Fast Track Hobbyworks
- OGR Publishing
- The N Scale Architect
- Rapido Trains
- Phoenix Sound Systems
- Xuron Corporation
- ScaleTrains.com
- Logic Rail Technologies

New Manufacturers



New Trainfest Displays

- Trainfest Celebrate-a-Railroad: Chicago & North Western Historical Display
- Dave Evans Display
- Illinois Railway Museum
- Let's Talk Trains
- Society of SE WI Land Surveyors
- Steel Mill Modeling SIG

S AT TRAINFEST

New Historical Groups

- American Passenger Rail Heritage Foundation's Rail Rangers Program
- Reading Co. Historical Society

New Layouts

- Royal Train Layout
- Randall Westphal

New Hobby Dealers

- Antioch Model Trains
- Charles McCreary
- Chris Curtale
- Lowell Smith Signature Series
- Mohawk Design Shirts
- Old Firehouse Collectibles
- Prairie Railway Display
- Rail Histories LLC
- Rails Unlimited
- Track One
- Trainz.com
- Tyler Neesan Sales





Barry from TrainmastersTV documenting the development process at our Southern China Engineering Office Team - from left to right: Shane Wilson, Mike Hopkin, Paul Ellis, Joe Olvera

ScaleTrains.com on Fast Track to Success

By: Alexandra Wietecha

ScaleTrains.com is poised to take the model railroading world by storm. This team of four model railroading enthusiasts believes they have discovered a way to manufacture new models with the potential to revolutionize the model railroading industry. ScaleTrains.com has chosen to make their grand debut at Trainfest 2015. In an interview with Shane Wilson, president of ScaleTrains.com, he said that the company was created on a foundation of striving for the “American Dream” of owning a successful model railroading business.

Shane’s first train-related memories go back over forty years to receiving a Marx train set for Christmas as a young child. By the time he was a teenager, Shane had built a door-size N Scale layout. Shane began to shape himself as a leader in the train world before he was even old enough to drive. He opened his own train-focused hobby store at age 16 and continued on to work at Horizon Hobby when he was 22, where he eventually helped start a model railroad category. Shane was a part of the Athearn acquisition team in 2004 and worked closely with the Long Beach team until his departure in 2014. As President of ScaleTrains.com, Shane’s primary responsibility is to support his team and ultimately their customers.

But even with all of Shane’s personal experience in the industry, he acknowledges that the dream of ScaleTrains.com would not have been realized without the help of what he likes to call their “model railroad dream team.” This team is made

up of Mike Hopkin, Paul Ellis, and Joe Olvera, who together with Shane make up a passionate team of model railroaders with over 120 years of combined experience. According to Shane, each member of the team is an investor in the company, so they have a strong commitment to support the modeling community and to the success of ScaleTrains.com. Mike has built contest level models and has been published in major model railroading magazines. Shane believes Paul is a walking encyclopedia of railroading knowledge. Joe’s passion for the hobby, quest for perfection, and incredible work ethic are what make his contributions to the team so special. Together, the team has played key roles in the development of some of the most critically acclaimed HO scale models, including the SDP45 and SD70 series models from Athearn.

After working for two different Southern California hobby retailers over the course of six years, Mike decided to move to Athearn where he spent the next 17 years. There he began in Quality Control and later moved to Product Development, where he led the team for 12 years by coordinating projects with the U.S. team, and the engineering and factories overseas. He now acts as the Vice President of Product Development for ScaleTrains.com. Because of Mike’s business connections in China, the team has been able to hire their own engineering team there and open a new factory with highly qualified people. His strong relationships have allowed the team’s development process time to be cut in half.

A lifelong model railroader, Paul put his vast railroading knowledge to good use as a graphic designer and R&D person at Microscale Industries, as well as through his most recent position at Athearn as a Product Developer, where he spent seven years. Shane believes the Executive Product Development Manager's amount of prototype knowledge committed to memory is so astounding that it helped the team provide research materials to their Engineering Team in China so quickly that they were able to begin model drawings within a couple months of launching the company. He also enjoys collecting full-scale diesel locomotive parts including horns, number boards, beacons, and even operating SP Gyalites. In addition to being a railroading collector, he has been prototype modeling in HO for over two decades. Paul loves to learn and share his techniques and knowledge with others while displaying his models at various RPM meets.

Over the past 15 years, Joe has worked for Microscale Industries, Slix Decals, and most recently at Athearn as the Graphics Design Manager. During his nine years at Athearn, he developed the templates used to generate artwork, created artwork to be applied to the finished model at the factory, and led the Graphics Design team to ensure paint and lettering accuracy. Joe is now the Vice President of Marketing at ScaleTrains.com. His past experience creating artwork to be applied to models provides for a great check-and-balance system for accuracy. Beyond all these impressive roles, Joe is also an accomplished freelancer and has created artwork for several model railroad, model car, publishing, and retail companies. Joe also loves to build complex contest-level plastic models including Sci-Fi and cars.

The team eagerly anticipates unveiling their new company and sharing their story the way it was meant to be shared—through interacting directly with other manufacturers, modelers, exhibitors, and train-lovers. Although many may expect manufacturers to dislike one another, Shane values his team's relationships with other model railroading manufacturers. Through the countless shows and events the team attends, they have been able to meet several manufacturer representatives who they love being able to rekindle relationships with at future events.



Our global headquarters in the mountains of Southeast Tennessee

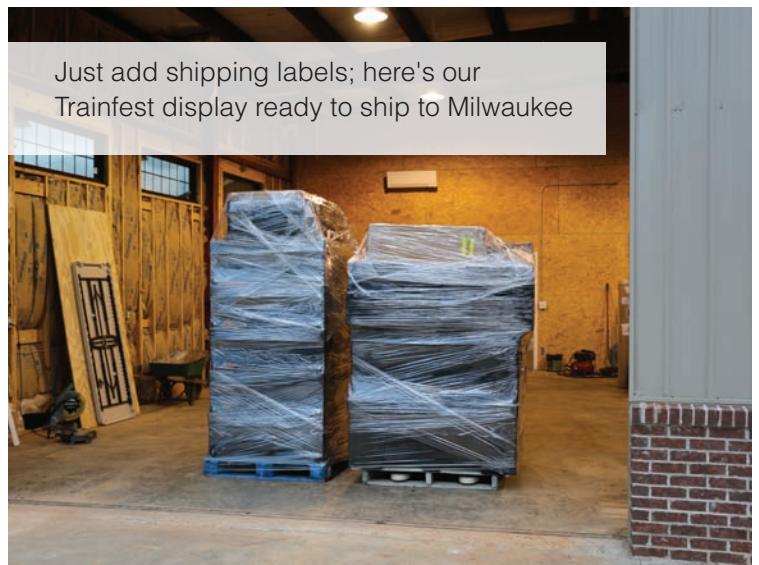

Just add shipping labels; here's our Trainfest display ready to ship to Milwaukee

The ScaleTrains.com team has chosen to unveil their company at Trainfest 2015. Having experienced the show in their previous careers the team recognized the value Trainfest brings to the model railroading industry. The team firmly believes that Trainfest is a must see event for every modeler. "It is a world-class event that entertains all train lovers—big and small" says Shane.

ScaleTrains.com strives to be unlike any other model railroading company on the market. "When [the team] started seriously discussing creating ScaleTrains.com, I challenged the team to come up with ideas that would differentiate us from everyone else," said Shane. The ScaleTrains.com team embraced this challenge looking at what the companies they looked up to were doing right, determining what practices could be improved upon, and pulled from their own extensive industry experience to create exceptional models and an unparalleled customer experience.

"Our goal has been to create models for every segment of the market from budget-minded products to models worthy of being displayed in the National Museum of American History in Washington, D.C.," said Shane.

With the understanding that their customers come from different walks of life and look at modeling in their own way, the company created their first locomotive with two different levels of details and features. Their first freight car will also be available in two variations— one targeted to the value-conscious customer and the other for "rivet counters."

ScaleTrains.com truly understands that without risk there is no reward. One of the first challenges they faced was the decision to leave the financial security of a long-standing, highly reputable model railroad company, risking their families' futures. The team ultimately seized the opportunity and began putting in long hours to create a workable business plan that would serve as a foundation for their company's future. With the business plan mapped out, ScaleTrains.com faced the challenge on how best to manufacture their products.

Continued on Page 14

Continued from Page 13

They established their own factory in China and hired a design team there. In this process the ScaleTrains.com team faced the challenge of learning to communicate with their design team on what they wanted, determining what was actually achievable, and confirming that everything they were doing was compliant with government rules and regulations. Thankfully the team has proven to be strong and passionate enough to face these challenges head on, and have let nothing get in the way of achieving their dream.

As ScaleTrains.com approaches their unveiling at Trainfest 2015, there is no sign of the team slowing down. Fueled by



Our factory in Southern China

their aggressive product development schedule, they have over 50 different all-new model projects “penciled-in” through 2023. Recognizing the high expectations set for themselves, the ScaleTrains.com team embraces their clear direction for the future. Through 2016, the company will be offering HO and N scale locomotives, freight cars, and vehicles, and have discussed expanding into structures, scenic details, and more.

Shane believes a significant part of the company’s success thus far is due to the “down-home” values of the families involved. They are constantly inspired by the legacy of the Stephens family, founders of Horizon Hobby, of creating the highest quality products while treating others as they themselves would like to be treated, and having a customer first approach always. The team is driven to earn the respect of the model railroading community and be considered a top-level manufacturer like many of the companies they look up to, including Athearn, Atlas, Broadway Limited, Walthers and Kato. Shane said, “Our company slogan is ‘Innovative ScaleTrains’, and we’re continually challenging ourselves to live up to our company promise.”

To meet the bright, new team, stop by the ScaleTrains.com booth during Trainfest weekend where they will be unveiling their company on Saturday morning. For more information on their company and products, visit ScaleTrains.com or ‘like’ them on Facebook. 

AZATRAX

Keeping watch on your layout

Smart infrared train detectors

*Advanced grade crossing and
block signal systems*

www.azatrax.com

Azatrax LLC, P.O. Box 6763, Longmont, CO 80501

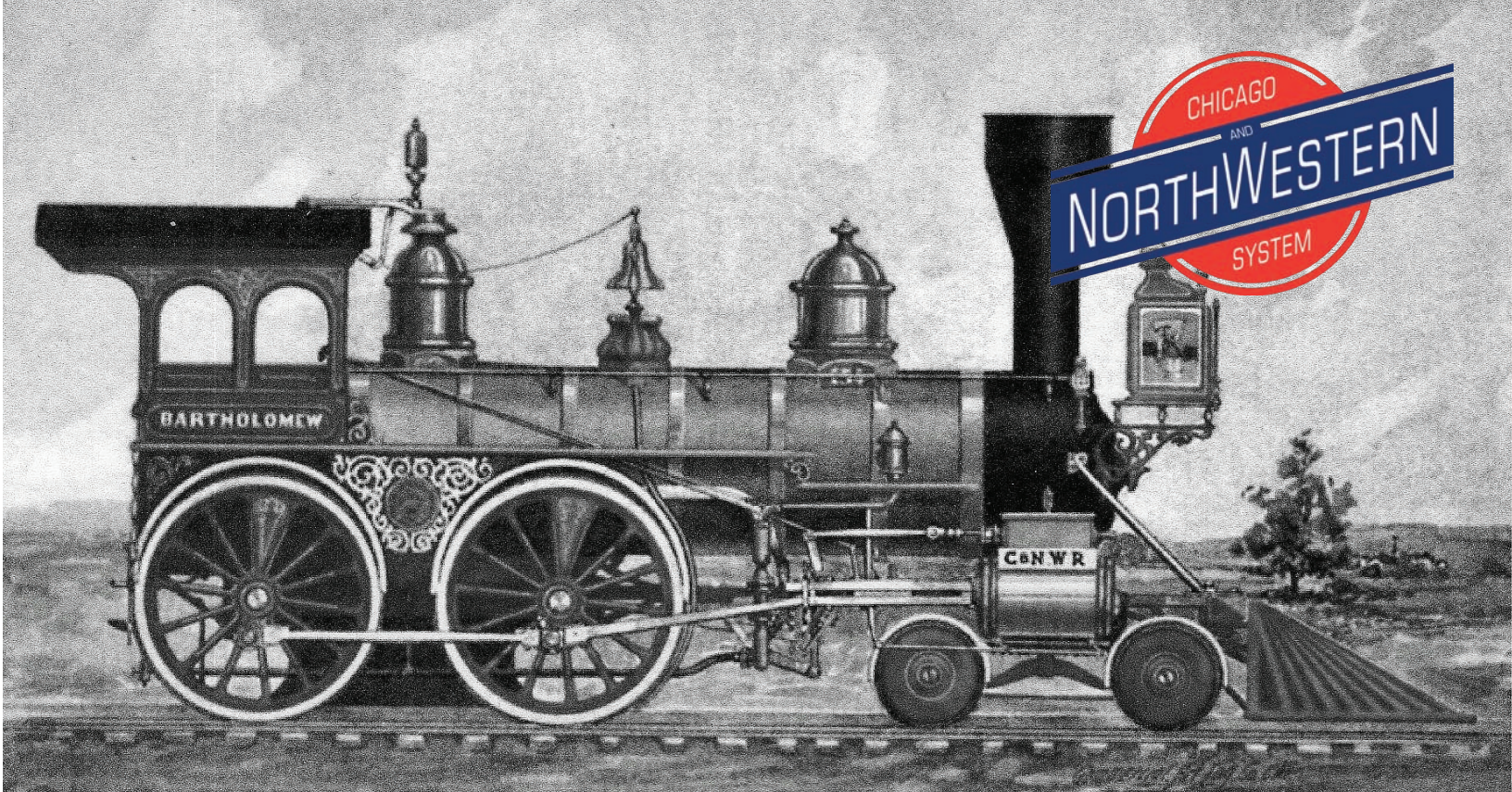

Celebrating C&NW

By: **Alexandra Wietecka**

Trainfest has been working on something brand new and exciting for Trainfest 2015. This year marks the start of a new tradition celebrating a different railroad each year. For each show, Trainfest will partner with railroad historical societies and other organizations to share memories and photos, to educate visitors on the history of the road and, of course, modeling that road.

In the program's inaugural year, Trainfest will be celebrating the Chicago & North Western System in conjunction with the C&NW Historical Society, the Milwaukee Historical Society, and the MSOE Grohmann Museum.

Visitors are going to find touches of the C&NW throughout the show. Walking through the main entrance to the Expo Center will be a museum quality historical photo display of the C&NW history and the people who ran, worked, and rode the railroad. Throughout the weekend, clinics will be held featuring topics such as the history of the C&NW, the equipment of the C&NW, modeling the road and more. Trainfest manufacturers have been encouraged to offer C&NW products and show layouts will be running their C&NW equipment.

A unique piece of artwork has been commissioned by Trainfest for the show. The painting features the Milwaukee Depot and the C&NW. Prints and cards of the artwork are available for purchase. 

Chicago & North Western... Quick History

Here is a quick look at the history of the C&NW. Don't miss the historical display at Trainfest for the full history of the C&NW!

According to the C&NW Historical Society, the C&NW was the largest and most profitable Midwestern railroad for a number of years. The first of the three lines within the system was formed in 1859 and the system continued to grow and add two more main lines through 1883. The C&NW reached its peak during the 1910s and 1920s. The C&NW's legendary president Marvin Hughitt retired in 1910, right as the system was completing its successful expansion absorbing smaller lines, building new depots, and installing signals on miles of single- and double-track roads. The C&NW had been doing very well until the system had to declare bankruptcy around the time of the Great Depression. An increase in highway and air traffic, and the overuse of equipment and infrastructure during WWII had the system fearful of a second bankruptcy in the 1950s.

When Ben Heineman took over as leader in 1956, the company began to focus on catching up on deferred maintenance, modernizing ticket and collection methods, revising schedules, and adjusting fares. The next forty or so years were a long series of ups and downs for the C&NW. By 1995, the C&NW was able to exit as a winner during its merge with the Union Pacific. 

Trainfest Layouts

O Scale

Layout	Run the Trains
Colorado Narrow Gauge (On30)	YES
Lionel RR Club Milwaukee	YES
Lionel RR Club SE WI	
Midwest Division TCA	YES
Milwaukee Electric Traction	YES
Schoedel Layout	
Southeastern WI Hi-Railers	

HO Scale

Layout	Run the Trains
Angel Figueroa Sotelo	
Arlington Heights Society of MRR Eng	
Bluff City Modular Engineers	YES
British Tram Layout	YES
Cedar Creek Central RR	YES
Cream City Traction	
Dead Rail Modeling in HO (Karkowski)	
European Train Enthusiasts	YES
Fond du Lac Society of MRR Hobbyists	
Gypsy Trolley Line	
Jaglinski Layout	YES
Kernels & Sanders Line	YES
Kettle Moraine Ballast Scorchers	YES
Lake County Society of Modular Eng	
Madison HO Trak	
Metro Model RR Club Ltd	
Milwaukee Electric Traction	YES
Modutrak	
MOO Crew	
Newer Industries Railroad	YES
North Shore & Western	YES
Northwest Traction Group	
Northwest Trainmasters	YES
Overland Western Lines	YES
Rusty Rails Layout	
SDRT Railroad	YES
Sheboygan Society of MRR Eng	YES
Swallow Cliff Model RR	YES
Waukegan Modular RR Club	
Wisconsin & Michigan RR Club	
Wisconsin Bits & Pieces	
WISE Division Youth Layout	

N Scale

Layout	Run the Trains
BSB N Scale Model Railroaders	YES
Capital City N Gineers	
Carlson Layout & Timesaver	YES
Central Indiana N-Trak	
Kettle Moraine Ballast Scorchers	YES
MANTRAK	YES
Milwaukee N Southeastern	
Modutrak	

S Scale

Layout	Run the Trains
Badgerland S Gaugers	YES
Ron Schlicht – American Flyer	
Steiner Layout & Demo	YES

Large Scale

Layout	Run the Trains
Glacial Garden RR	YES
Kenosha Garden RR Society	
LGB Model RR Club of Chicago	YES
Midwest Rails	YES
Wisconsin Garden RR Society	YES

Standard Gauge

Layout	Run the Trains
Standard Gauge Module Assn	YES
Wisconsin Standard Gauge Operators	

Z Scale

Layout	Run the Trains
Randall Westphal	YES
Royal Train Layout	
WIZ KIDS Z SCALE	

Specialty Scale

Layout	Run the Trains
Blau Pewaukee Road Lego	YES
Milwaukee Light Engineering Society (Train Ride)	

One Man's Trainfest Motivation

Interview with Ken Jaglinski, Trainfest Chair

Before the big show, we took some time to sit down with Ken Jaglinski, Trainfest Chair, to discuss model railroading and Trainfest.

Trainfest EXPRESS: Where does your passion for all things trains stem from?

Ken: Growing up, my family lived near the Northwest tracks. I developed an interest in trains from always being around the track to the model trains I had as a young kid. I remember as a teen going to the tracks to watch the trains.

TE: How did you get started in modeling?

Ken: I began modeling as a teen, but I didn't get too serious about it until after college. Once I had my own home I really began to get into the hobby.

TE: What scale is your favorite to build and why?

Ken: I mostly model HO Scale. For me, N Scale can get too small while O Gauge can eat up an entire basement.

TE: What is the setting of your home layout?

Ken: I enjoy modeling buildings so my home layout is a city theme. It is actually three cities combined into one large city. I love to "kitbash," using multiple kits and creating a unique model using different elements from each kit.

TE: What are some of the biggest challenges you've faced with layout construction?

Ken: My biggest challenge was dividing the layout into operational power districts for better operations.

TE: How has your role as Trainfest Chairman impacted your modeling?

Ken: Well it has taken time away from it! When balancing my time, Trainfest comes first, modeling second. When I do find time for modeling, I work with some friends on a portable layout which we will be bringing to Trainfest.

TE: What advice do you have for individuals getting started in the hobby?

Ken: Don't be afraid to start slow. Remember, you can always make changes as you get more proficient in your modeling skills. Also, get involved with your local NMRA Division as there is a lot of knowledge and experience to be shared by long time modelers.

TE: What do you think makes the Trainfest experience different from other model railroading shows?

Ken: It's the multitude of operating layouts. Every year it is impressive to see 70+ operating trains together in one place. Also, Trainfest is geared to not only the modeler but also families to promote the hobby to the next generation. Last year we truly saw this in action with the Make 'n Take clinics where modelers volunteered to help kids build a model station stop.

TE: What are you most excited for this year?

Ken: The Celebrate-a-Railroad program, especially the historical display showcasing the history of the Chicago & North Western. I am looking forward to bringing this new tradition to Trainfest of honoring historical railroads and the impact the railroad industry has made on this country. 

TRAINFEST SHOP ONLINE



Before you head to the show check out the Trainfest Online Shop!

As a part of the Celebrate-a-Railroad program, Trainfest is excited to announce a special limited edition HO Scale Chicago & North Western Evans 5100 cu.ft. 50' boxcar, manufactured by ScaleTrains.com. This is a limited run of only 600 boxcars. Two road numbers are available, 600632 and 600639.

The boxcar, as well as select pins and plaques from past Trainfest shows are available for sale at the Trainfest Show Office.



COUNTRY
INNS & SUITES
BY CARLSON™

"The HOTEL you can come HOME to."

THE BEGINNING PIONEER RAILROAD 18

1846



In 1846 William Butler Ogden, the first mayor of Chicago, became the third president of the G&CU. By 1848 he and his partner J. Young Scammon raised \$350,000 in capital through subscriptions, to allow the Railroad to start laying track.



A Brief History of the Chicago and North Western Line

The Pioneer, the first locomotive of the Road, arrived at Chicago from New Buffalo, Michigan on October 10, 1848, nearly thirteen years after the charter was granted. On October 25, 1848 the Pioneer pulled the first westbound train out of Chicago to the end of the line in the present Chicago suburban town of Oak Park.



1850

In 1850, the Galena and Chicago Union Railroad was completed far as Elgin and by 1853 it reached Freeport, Illinois. However, the Central had already reached Chicago so the line was redirected at Galena to take a more direct route to the Mississippi River.

Yesterday and Today,
100 years of Progress,
1848-1948

The Galena and Chicago Union Railroad (G&CU), the first railroad to run out of Chicago, was chartered on January 16, 1836. The Railroad intended to connect Chicago to the lead mines at Galena, a town in Illinois larger than Chicago.



"THE TRAIN THAT SET THE PACE FOR THE WORLD" THE "400"

The first 400 train was pulled by a steam locomotive and could make the 409 mile trip from Chicago to St. Paul, Minnesota in as little as 390 minutes. Unlike the lightweight streamliners that had emerged in 1934, the first 400 was a conventional train with standard heavyweight cars. The train generally ran with six cars that had air conditioning, updated interiors, and hot water in the coach lavatories.

1934

1939

Despite the success of the 400, in 1938 the C&NW made plans to purchase 20 streamlined cars and four diesel-electric units for the 400. The diesels were introduced in 1939, but the original 400s, renamed the Twin Cities 400, continued to run with non-recliner coaches until 1963.

The first full C&NW streamlined train made its inaugural roundtrip from Chicago to Milwaukee on September 18, 1939. The standard order of cars was a baggage-taproom-lounge followed by four 56-seat coaches, a 56-seat dining car, three 27-seat parlor cars, and a club-observation car. All were appointed with the most modern decorations, lighting, and conveniences. The trucks of the cars were also redesigned to provide an exceptionally smooth ride.

Regular service for the streamlined 400s began on September 24, 1939. These trains were immensely popular in their early days and proved to be worthy competition for the Chicago, Burlington, and Quincy's Twin Zephyrs, and the Milwaukee Road's Hiawathas. In addition to the Chicago to St. Paul route, the C&NW operated several other routes with a number of 400s bearing names such as the Minnesota 400, the Flambeau 400, the Peninsula 400, and the Kate Shelley 400.

"North Western" ENLARGES ITS GREAT "400" FLEET
BUILT BY PULLMAN STANDARD



Each, however, remarkable, the "400" has won distinction among the great trains of America. Now, the railroad who have purchased the "400", have given them a service second to none in regularity both in passenger volume and operating records. Now come the first passenger additions to this fleet, popular first class Pullman Standard built cars, to provide greater capacity for weather, demand for greater comfort and the best in service to travelers along the "Route of the 400's".

The high quality in the lines of the "400" trains are the result of years of collaboration between Pullman Standard and the Chicago and North Western Railway. Both groups by progressive passenger car development Pullman Standard built the first lightweight streamlined cars for any railroad. The North Western, however, has a long record of successful operation of this new equipment. Since 1915, we have built 118 lightweight cars for this railroad, as for the joint operation with Great Northern and Southern Railway.

Watch for Pullman Standard "Estate of Today" for the right and place in modern rail transportation travel as never before. Pullman Standard built cars.

Pullman-Standard CAR MANUFACTURING COMPANY
CHICAGO-ILLINOIS Offices in many cities... Manufacturing plants in the U.S.A.
World's largest builder of modern streamlined railroad cars

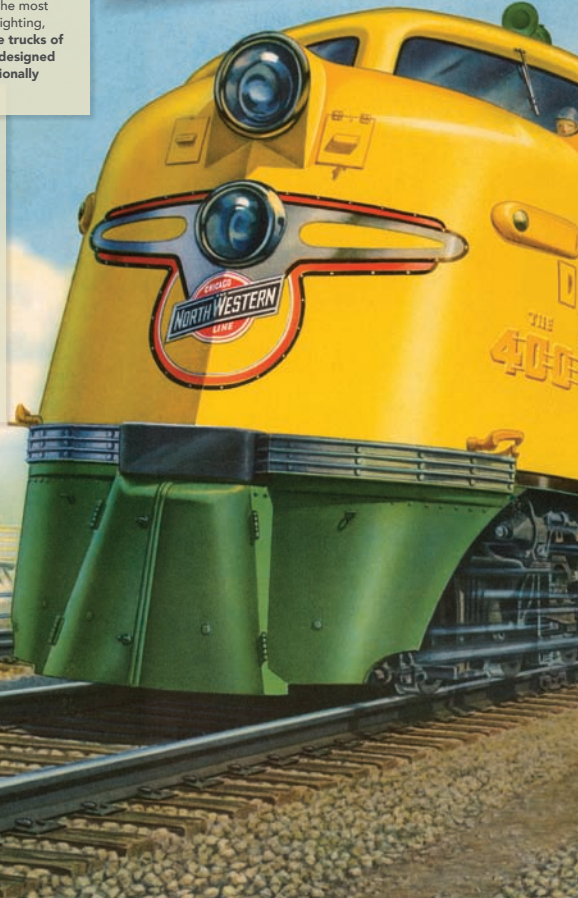

Four of 32 huge panels telling the story of the C&NW. Display is located just south of the main entrance.

A MUST SEE THIS YEAR
- Celebrating the Chicago

Fastest Train Title Goes to C&NW

With the addition of a stop at Waukegan the Chicago & North Western's 9:05 a.m. City of Milwaukee "400" from Milwaukee to Chicago now makes the 15.66 miles from Kenosha to Waukegan in 11 minutes at an average of 85.4 miles per hour.

about a mile from Waukegan. Acceleration is helped a little by the fact that Waukegan station is 40 feet lower than Kenosha, and while the first mile out of Kenosha is very slightly upgrade, the loss in elevation follows immediately and before the train is up to full speed. The rest of the run is along the lake shore flats.

Examination of the train sheets shows that No. 156 has been making the difficult time day after day. The train is pulled by a 2000 horsepower Electro-Motive Diesel and is made up of six light weight Pullman-built cars totaling 350 tons behind the locomotive. The line is double track, automatic block signaled, and has no grade crossings of other than secondary roads. Curvature is very slight and the lake front flat offers a natural speedway.

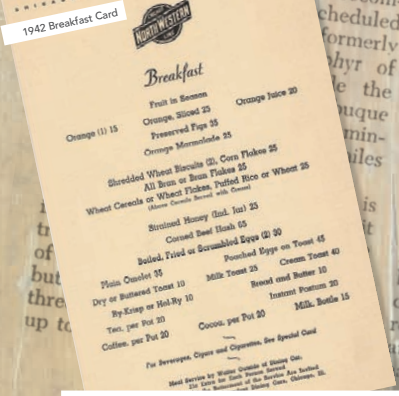

CHICAGO & NORTH WESTERN UNCHARTERED

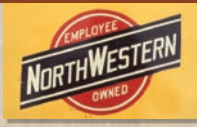

1855
The line was run out to Kenosha and the G&CU rate trains by 1855 — the first to do so.

1855
ran from Turner (near Chicago) to New Orleans on the Mississippi River and became the basis for the route to the west.

1855
and a second track was laid and started left in order to avoid spots to the other side.



DISHING exhibits from a hat should be long for Allen Slaughter, former chef on the Chicago & North Western Railway's "400". The amazing output from his tiny kitchen is indicated by a few of the items that pass through his hands in the course of a year... Five tons of roast beef, five tons of plain steak, three and a half tons of poultry. The Northwestern line is one of 217 American railroads using Olin machines exclusively for copies of accounting statements, forms, telegrams, shipping bills, pricing card reports, shop orders, advertising notices and notices, etc.



1858
G&CU runs across the Mississippi to reach the Missouri River

1858
In 1858, the G&CU operated the first sleeping car west of Chicago on the line to Freeport.

1862
In 1862 the G&CU leased the Cedar Rapids and Missouri River Railroad line in Iowa. It would eventually become a mainline portion of the transcontinental railroad for the Chicago & North Western.

1867
The C&NW built the first railroad mail car in the United States in 1865 and put it into service in 1867.

1869
The Railway Mail Service was in full swing



1865
In 1850, the Galena and Chicago Union was contracted by the United States Post Office to carry "pouched mail" and small packages. While trains had been carrying mail in the East for several years, delivery in the "West" was uncharted territory. In fact the Iowa Division of the Chicago and North Western Railroad, from Chicago to Clinton, Iowa, became the first "West" railway postal route in operation on August 28, 1864. The earliest complete railway post office cars were built for the C&NW in 1865, put into service in 1867, and by 1869 the Railway Mail Service was in full swing with virtually all mail being carried by railroads.



Mail car awaits sorting of mail.

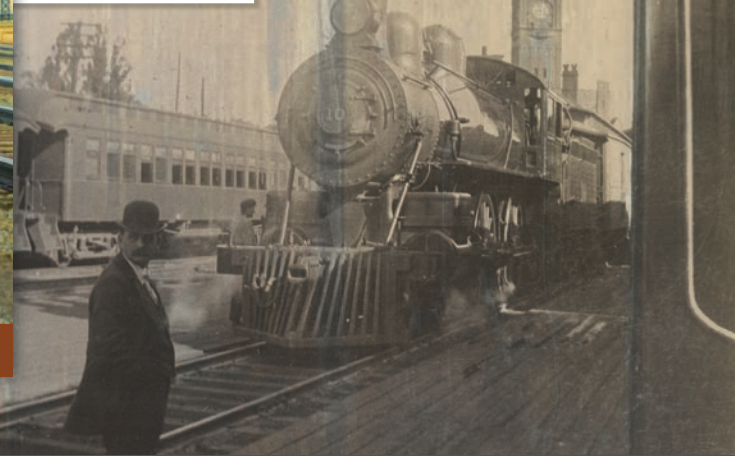

MEET AT TRAINFEST!
Chicago & North Western -

SATURDAY CLINIC SCHEDULE

Time	C&NW Historical Society Classroom 1	Niagara Frontier Region Classroom 2	Trainfest Clinics Classroom 3	Trainfest Clinics Classroom 4	Upstairs Glass Conference Room
10:00 AM	Introduction to C&NW	Trees of the Northern Forest	Build a complete Layout in 1 hour with the RR in a Box Quickie Line Kit	Answers To FAQ of Using Styrofoam in Model Railroading	
11:00 AM	Why model the C&NW?	Simple Weathering Without Airbrushing	Weathering Techniques with Pan Pastel Colors	Tangent Scale Models: An Overview of Our Models	Using The New Chooch Paints And Flexible Walls
1:00 PM	Modeling C&NW Locos	Tools Of The Trade	Paper Models For The 21st Century	MRC's DCC System	
2:00 PM	Chicago Great Western in Action	Scenery For Model Railroading	General Coupler Conversion Info and Other Kadee Stuff	Applications of Hunterline Weathering Mix	
3:00 PM	C&NW in Action	Sign, Sign, Everywhere A Sign	Braking, Switching & Running: Railroading with Tsunami	Z-Stuff Product Applications	
4:00 PM			First Two Years on the St Louis Division	Steel Mill Modeling	

SUNDAY CLINIC SCHEDULE

Time	C&NW Historical Society Classroom 1	Niagara Frontier Region Classroom 2	Trainfest Clinics Classroom 3	Trainfest Clinics Classroom 4	Upstairs Glass Conference Room
11:00 AM	C&NW in Action in Northwest Wisconsin	Low Budget Ideas for Model Railroading	Build a complete Layout in 1 hour with the RR in a Box Quickie Line Kit	Applications of Hunterline Weathering Mix	Using The New Chooch Paints And Flexible Walls
1:00 PM	Modeling the C&NW Covered Hopper Fleet	Arduino Uno and Model Railroading	Manufacturing - Industry Trends and The Local Hobby Shop	Tangent Scale Models: An Overview of Our Models	
2:00 PM	Modeling C&NW Station Stops	1950's Freight Cars for Your Model Railroad	Braking, Switching & Running: Railroading with Tsunami	All Access Pass: ScaleTrains.com Factory Tour	

VISIT THE WALTHERS BOOTH AT TRAINFEST 2015

ENTER FOR YOUR CHANCE TO WIN A
TRAINSET OF YOUR VERY OWN!

ALL ARE WELCOME -
BEGINNERS,
SEASONED MODELERS
AND EVERYONE
IN BETWEEN!

BEGINNERS,
LEARN HOW TO BUILD
A SIMPLE LAYOUT
IN A WEEKEND.

MODELERS,
COME SEE WHAT'S NEW.

GET SPECIAL OFFERS TO HELP YOU SHOP
AT THE SHOW AND CLOSE TO HOME

**BIG
ANNOUNCEMENTS**

**EXCITING NEW
PRODUCTS FROM**

MAKING RAILROAD HISTORY
WALTHERSPROTO™

MAKING RAILROAD HISTORY
WALTHERSMAINLINE™

MAKING RAILROAD HISTORY
WALTHERSTRAINLINE™



SCENEMASTER™

VEHICLES, SCENERY, FIGURES AND MORE!

**AFTER THE SHOW,
BE SURE TO VISIT
OUR SHOWROOM
IN MILWAUKEE**



Wm. K. Walther's, Inc.
5601 W. Florist Avenue
Milwaukee, WI 53218

WALTHERS®

MILWAUKEE-BASED, FAMILY OWNED AND OPERATED SINCE 1932
VISIT WALTHERS.COM • CALL 1.800.4.TRAINS

Kids' Activity Zone

Bigger Than Ever Before

New Layout

This year at Trainfest, the Kids' Activity Zone has been expanded to be bigger than ever before! Just look for the MLES train ride and you will find the Kids' Zone occupying the space inside the tracks!



Based on last year's popularity, the Make 'n Take Clinic space is over 5 times larger! Also located within the tracks will be the Choo Choo Bob Concert stage, the Midwest Division TCA Train Races, and the Blau Pewaukee Road LEGO® layout and LEGO® build and play area.

MLES

Back by popular demand the Milwaukee Light Engineering Society will be bringing their rideable scale train and 600ft of track. Rides are available both show days and are **FREE** (*donations accepted*).



Young Modeler

Model railroading attracts enthusiasts of all ages. Last year Angel Figueroa Sotelo debuted his first layout at Trainfest, at age 7! He will be returning again this year, and we are excited to see how his layout has grown over the past year!



Trainfest Kids Passport

New at Trainfest 2015 is the Kids Passport, printing to appearing on page 26. Print it out and bring it to Trainfest as your family's guide to Trainfest 2015. It is full of activities for kids of all ages! Once you have checked off 5 stops, return your passport to the Kids' Activity Zone for a chance to win a Train Set!



Trainfest Junior Engineer

Are you looking to take your Trainfest experience to the next level? Is your young train fan ready to be a certified Trainfest Junior Engineer? Then be sure to stop at the WISE Division booth to sign up for the Junior Engineer Program. Be sure to stop at the WISE Division booth to sign up for the Junior Engineer Program, and you will receive your Operations Test Card. Once you have completed your tasks, return the completed card to the WISE Division booth to receive your certification!



Did you complete your level 1 Junior Engineer at Trainfest 2014? ...Remember to bring your Junior Engineer card to Trainfest this year to complete a new set of task and receive your Trainfest Junior Engineer Level 2 Certification!

Trainfest®

America's Largest Operating Model Railroad Show

JOIN — THE — FUN



WI State Fair Park

Sat. & Sun. Nov. 14 - 15

9:00

MAKE N'TAKE

Kids 7-12 years old build their own Whistle Stop Station. Register in advance at trainfest.com. *Sponsored by Walthers Model Trains*

Sat. & Sun. 9:30 – 3:30 hourly

RUN THE TRAINS

Kids 5 and up can run the trains. Look for the "Run this Train" signs at participating exhibits.

TRAIN

Visitors of the Milwaukee Engineering train. They rideable train of track! Su with a volun

WOODEN TRAIN TABLES

Courtesy of Choo Choo Bob, kids 2-4 can take a break to play with trains. *Sponsored by Walthers Model Trains*

CHOO CHOO BOB SHOW

From the popular TV show, Choo Choo Bob, comes an acoustic performance for kids of all ages. *Sponsored by Walthers Model Trains and courtesy of Choo Choo Bob.*
Sat. & Sun. 11, 1, 3





10:00am- 5:00pm

KIDS' ACTIVITY ZONE

FREE WITH ADMISSION. CHILDREN NEED TO BE ACCOMPANIED BY AN ADULT.

TRAINS

All ages can ride the Milwaukee Light Rail Society (MLRS) train. We are bringing their train and nearly 600ft of track to support the train. A monetary donation.

MAKE YOUR OWN PICTURE FRAME

Make your Own Picture Frame. Kids 4-7 create their own fall photo frame. While supplies last.
Sat. & Sun. 9a – 5p

TRAINFEST JUNIOR ENGINEER PROGRAM®

Learn everything about trains to become an official Trainfest Junior Engineer (Ages 5-16). Receive a membership card, a button, and a certificate. Sign up at the WISE booth.

STORY TIME

Listen to fun train stories read by Choo Choo Bob Engineers. *Sponsored by Walthers Model Trains*
Sat. & Sun. 11:45, 1:45, 3:45

LEGO® PLAY AREA

Build and play in the LEGO activity area. *Presented by Blau Pewaukee Road.*

LARGEST SHOW EVER 5 FOOTBALL FIELDS OF MODEL TRAINS

70 HUGE OPERATING MODEL RAILROADS!

Saturday & Sunday
Nov. 14 - 15, 2015

Want to go home with your very own train set? Travel through the Trainfest stops to fill up your passport for a chance to win! (more details on back)



Once you have traveled through Trainfest, bring the back page of this passport to the Kids' Activity Zone to be entered for a chance to **win a train set**. To enter check off at least 5 stops and fill out the form below.

Name: _____

Parent/ Guardian name: _____

Phone #: _____

Email Address: _____

How did you hear about Trainfest? _____

Favorite Trainfest Activity? _____



1. PRINT
2. FOLD ON THE DOTTED LINE
3. BRING TO TRAINFEST THIS WEEKEND!

WIN
a Train set!



KIDS' PASSPORT



Saturday & Sunday
November 14 - 15, 2015

- Ages 7-12**
- Make 'n Take:**
- Have you seen some of the amazing work done by the craftsmen at Trainfest? You can assemble your own Whistle Stop Station kit over in the Kids' Activity Zone and take it home to start your own layout. Pre-registration is recommended at Trainfest.com
 - Want to make your new train expertise official? Sign up for the Trainfest Junior Engineer Program at the WISE Division Booth.
- Fun for the Whole Family**
- Train Ride:**
- You've seen tons of model trains on their tracks today. Now go ride one! The Milwaukee Light Engineering Society train runs on 600ft of track!
 - Run the Trains: There are over 50 trains you can run at Trainfest! Step into the Engineer's seat!
- Trainfest Trolley Barn:**
- Get lost in the beautiful garden railroads at the Trainfest Trolley Barn!
- Walters:**
- Stop by the Walters' booth to view new projects for young train fans and modelers alike!
- Scale Trains:**
- Check out the extreme detail on this new manufacturer's Museum Quality models!

- Ages 2-4:**
- The Choo Bob Show:**
- Do you want to hear some lively train tunes? Stop by the stage in the Kids' Activity Zone to hear the cast of the Choo Choo Bob Show perform some of his most popular songs. Show times: Sat. & Sun. 11, 1, 3
- Story Time:**
- Head over to the stage with your engine-ears open to listen to the Choo Choo Bob engineers read their favorite train books during story time! Sat. & Sun. 11:45, 1:45, 3:45
- Wooden Train Tables:**
- Choo Choo Bob has again brought wooden train tables to Trainfest. Get a head start as an engineer and lead the trains through the tracks.
- Ages 5-7**
- Train Craft:**
- Bring Trainfest home with you! Drop by the craft area in the Kids' Activity Zone to make your own photo frame!
- LEGO®:**
- Recreate the trains you've been seeing today in LEGO form! Stop by the Blau Pewaukee Road to see a railroad made entirely out of LEGO and a LEGO Brick build and play area.

GETTING THE MOST OUT OF THE MODEL RAILROADING HOBBY

Join the NMRA. Become a member of the Wisconsin Southeastern Division.

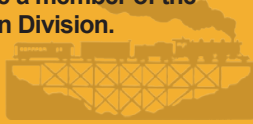

What is the NMRA?

The **National Model Railroad Association (NMRA)** was established in 1935 in Milwaukee, Wisconsin, to bring model railroaders together to foster fellowship and provide resources to hobbyists. The NMRA is a worldwide non-profit educational association. The organization is divided into geographic regions to best provide local support and camaraderie to model railroaders. Visit www.nmra.org.

What is Wisconsin Southeastern Division, Inc.?

The Wisconsin Southeastern Division (WISE Division) is made up of NMRA members living in the seven Southeastern Wisconsin counties of: Kenosha, Milwaukee, Ozaukee, Racine, Walworth, Washington, and Waukesha.

With an educational mission to promote the model railroading hobby, the Wisconsin Southeastern Division creates opportunities for modelers who are "new and not-so-new" to the hobby to share new ideas and information. The division sponsors free model railroading meets.

The Division also sponsors a group for young modelers and train enthusiasts to get started in the hobby.

Visit www.wisedivision.org.

What is Trainfest®?

One way the Division pursues its mission is through its annual event, **Trainfest**. Hobbyists, hobby dealers, manufacturers, and rail fans of all ages come together at Trainfest for two days to celebrate everything trains. Trainfest is the hub for bringing together new and experienced modelers to share ideas and pass on the passion for modeling to the next generation. What could be more fun?

Become a member. It's Easy!

To join, speak with a Division member or visit our website at www.wisedivision.org. If you live outside of Southeastern Wisconsin, please visit www.nmra.org to contact your local NMRA Division.

Trainfest®

America's Largest Operating Model Railroad Show.



www.trainfest.com

Trainfest is sponsored by the Wisconsin Southeastern Division, Inc.

Visit
Trainfest.com
for more
details.

Sponsors & Friends

Trainfest would like to thank our sponsors and friends for their support and donations to Trainfest 2015:

Kids' Activity Zone Sponsors



Choo Choo Bob Performances
Make 'n Take Kits



Wooden Train Tables



BILLY CARR
The Texas Tool Man | 817.313.9555

Promotions Partners



Media Partner



Kids' Passport



Celebrate a Railroad Collaborating Partners



Chicago & North Western
Historical Society



Trainfest is presented by the Wisconsin Southeastern Division of the NMRA and would not be possible without the support of our sponsors and model railroading friends. Thank you!

National Associations



NOV.
11 & 12
2016

Trainfest[®]
America's Largest Operating Model Railroad Show



**JOIN
THE
FUN**

**OPERATE
THE
TRAINS!**

HELD ANNUALLY
2nd Weekend of November

WI State
Fair Park

- GREAT FAMILY EVENT**
- 70 huge operating model railroads
 - 110 Manufacturers & Hobby Dealers
 - FREE Kids' Activities
 - Ride the MLES Train

Trainfest.com
DISCOUNT TICKETS ONLINE

AMERICA'S LARGEST OPERATING MODEL RAILROAD SHOW

Sponsored by the Wisconsin Southeastern Division, Inc. of the National Model Railroad Association

5 FOOTBALL FIELDS OF MODEL TRAINS



**FREE
Modeling
Clinics**

**FREE
TRAIN
RIDE**

